

SLOAN[®]
Water Connects Us[®]

Faucet and Soap Dispenser Full Line
Functional elegance by design



A full line of faucets and soap dispensers to meet your needs

Selecting a faucet and soap dispenser for commercial applications is no simple task. The faucet and soap dispenser represent a critical point of interaction — the culmination of a positive, hygienic experience that begins with a designer or architect's vision. For maintenance teams, facility managers, engineers, and contractors, it's all about reliability, ease of installation, and time savings.

As the inventor of sensor-operated faucet technology, Sloan has created the most comprehensive line of electronic sensor faucets and soap dispensers for the widest array of applications. With more styles, designs, and options than any other manufacturer in the business, it's easy to find the perfect solution to meet all your needs while staying within budget.



Premier

Our premier product line features fully-customizable, durable hardware and includes hidden sensors for a clean aesthetic. Each premiere faucet is available in our full range of special finishes and has matching soap dispensers and hand dryers to complete your restroom vision.

Matching hand dryers available for use with AER-DEC® Integrated Sink System.



Deluxe

Discover our range of deluxe touch-free faucets and soap dispensers that bring elegant, fluid forms to any restroom design. Select deluxe faucets are available with matching soap dispensers and come in a full range of special finishes.



Standard

Our tried and true standard faucets and soap dispensers offer affordability — without sacrificing performance.



Legacy

Our original line of sensor-operated faucets. These products are hard-working and vandal-resistant to keep facilities in working order.

The Complete Commercial Restroom

Our sensor faucets and soap dispensers perfectly complement all of our sinks, hand dryers, flushometers, water closets, urinals, and more to complete your commercial restroom.



Optima® ETF-410 Faucet and ESD-410 Soap Dispenser in Polished Brass on SloanStone® ELGR-84000 Gradient Sink in SloanStone Matrix White with angled stainless steel enclosure.

SPECIAL FINISHES



Special Finishes

**Add the finishing
touch to your project**

Special Finishes

Elevate your next commercial restroom design with our exciting range of special finishes to help create a unified restroom experience. With our special finishes available for faucets, soap dispensers, hand dryers, and flushometers, you can ensure a consistent color match between products.

BENEFITS

- Ensures matching finishes across restroom fixtures
- Creative flexibility for architects and designers
- Durable and stain resistant
- No additional lead time for products that are part of Sloan's special finish program



Make a bold statement with Polished Brass.

Create the aura of high-end luxury and transform your space with Polished Brass. This warm finish will catch the eye of everyone who walks in the room.



Revitalize your environment with Brushed Nickel.

With fewer fingerprints and water marks left behind, the Brushed Nickel finish remains sharp and clean even after high-traffic use in any environment.



Keep it clean and efficient with Brushed Stainless.

The Brushed Stainless finish hides most fingerprints and water marks, keeping your restroom clean no matter the environment.

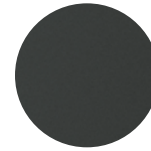

Blend into the design with Graphite.

The Graphite finish blends in with any contemporary setting where a sleek and sophisticated look is desired.



Get more durability and consistency with Sloan's proprietary Physical Vapor Deposition (PVD) special finishes.

Sloan's proprietary Physical Vapor Deposition (PVD) special finish process enhances our products' resistance to chemicals and abrasion by bonding the finish at the molecular level. This innovative technology is an essential solution for curved and angled products that are difficult to coat. When compared to powder coating or immersion processes that are typically used, the durability of PVD ensures a long-lasting finish that will stand up to commercial use.

Shown opposite left: BASYS® EFX-250 Faucet and ESD-500 Soap Dispenser in Polished Brass on Designer Series™ DSOF-82000 Open Front Sink in Corian® Silver Birch with cabinet style enclosure in Wilsonart® Wheat Berry laminate.

Shown opposite right: Optima® ETF-420 Faucet and ESD-420 Soap Dispenser in Brushed Nickel on Designer Series DSCT-82000 Counter Top Sink in Corian Designer White.

Shown opposite bottom: Optima EAF-250-ISM Faucet and ESD-2000 Soap Dispenser in Graphite on Designer Series DSWD-82000 Weir Deck Sink in Corian Glacier White with optional stainless basin grate and cabinet style enclosure in Wilsonart Black laminate.

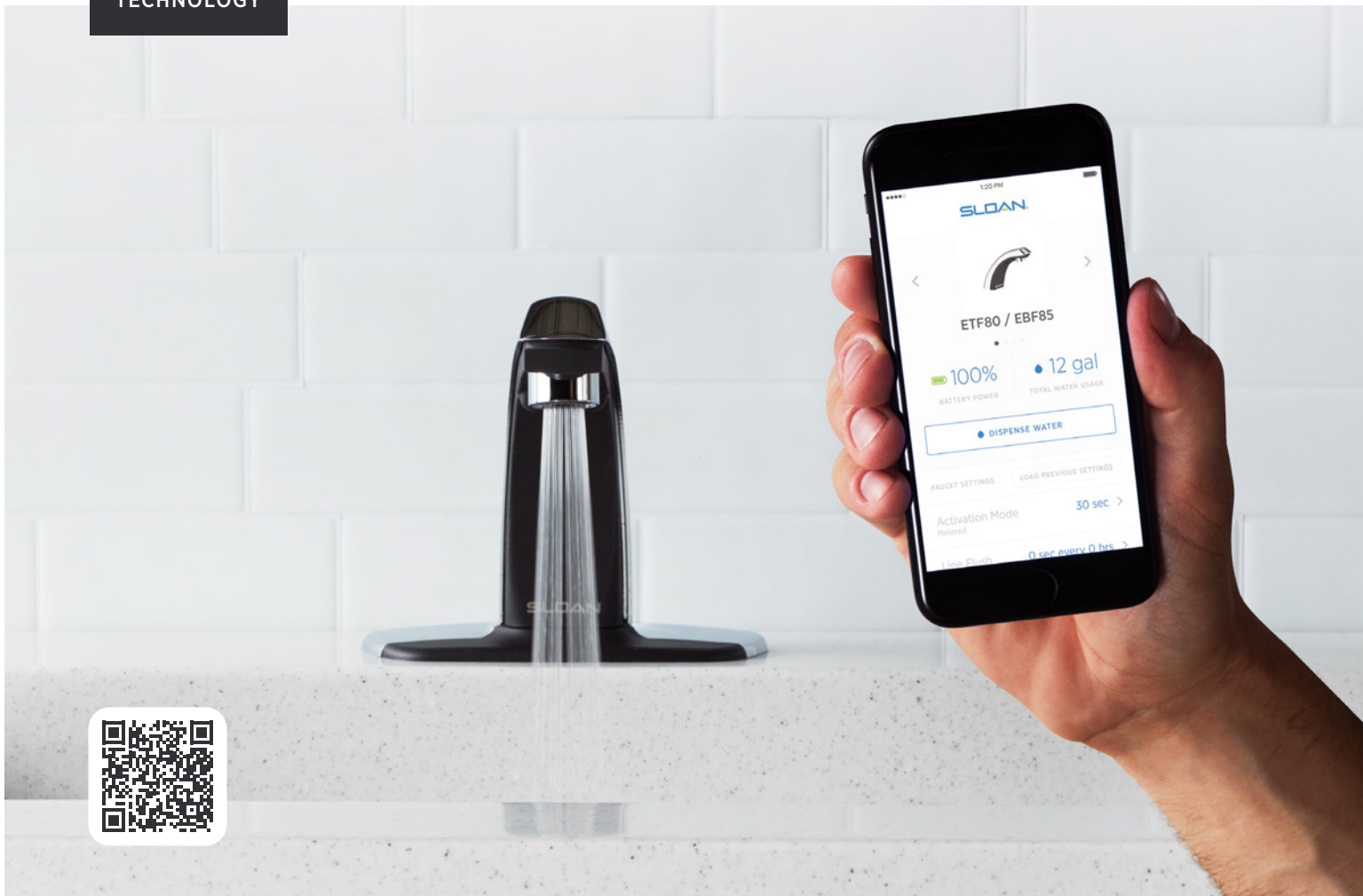

Simply connect to monitor and adjust with the Sloan Connect® App.

Adjust and configure your Sloan Bluetooth-connected faucets from your smartphone, and see how your fixtures are performing. Quickly adjust settings wirelessly to reduce maintenance time and cost. Access technical data, and share diagnostic reports for swift and easy maintenance and troubleshooting.

Download the free Sloan Connect App for iOS and Android.



FEATURES AND BENEFITS

- Adjust settings wirelessly (no deck disassembly or below-deck work required)
- Select on-demand or metered activation
- Set faucet timeouts
- Activate line flush to clear supply lines or drains
- Measure and report water usage
- Check battery strength
- Identify your faucet and access technical data
- Generate and share diagnostic reports with Sloan
- Save notes about site or faucet



Optima® Control Box

Meet the revamped Optima Faucets from Sloan. The most innovative water management system on the market has fewer parts and more standardized components, helping to reduce installation and maintenance by 50% or more.

At first glance, you'll see that new technology means fewer cords and fewer hoses. The same control unit can be powered by batteries, hardwire with battery backup, or optional hybrid energy turbine.

FEATURES AND BENEFITS

- Accepts 6 VAC or 24 VAC power supply
- Removable battery cartridge for easy replacement
- Plug and play connection with shielded cables
- Dual inlet filter fitting contains a built-in water filter and allows for hot and cold water mixing
- Easy inlet and outlet installation
- Up to 6 faucets can be connected to a single power source
- Provides Bluetooth connectivity to faucets

Add Bluetooth connectivity to your new or existing BASYS® EFX and hardwired Optima EAF Faucets.

Give your BASYS EFX and hardwired Optima EAF Faucets a smart upgrade with our easily installed EAF-1025 Bluetooth Adapter. It installs under the deck with plug-and-play convenience. Simply connect the adapter into the faucet cable, and the firmware will automatically update.

Note: Optima ETF/EBF Faucets have Bluetooth capability integrated. No adapter needed.



Power options

With four power options, you have total flexibility with your application needs. Narrow faucets down by the ideal power type on our faucet filter page at sloan.com/faucets.



Battery

A good option for retrofit environments or installations where hardwiring is not available.



Solar

An excellent choice to passively harvest power and extend battery life from artificial or natural light sources.



Hardwired

Ideal for new construction because it eliminates regular use of disposable batteries. Many hardwired models include a battery back-up to eliminate loss of function if power loss occurs.



Turbine

Miniaturized hydroelectric turbines extract power from moving water and use it to extend battery life.

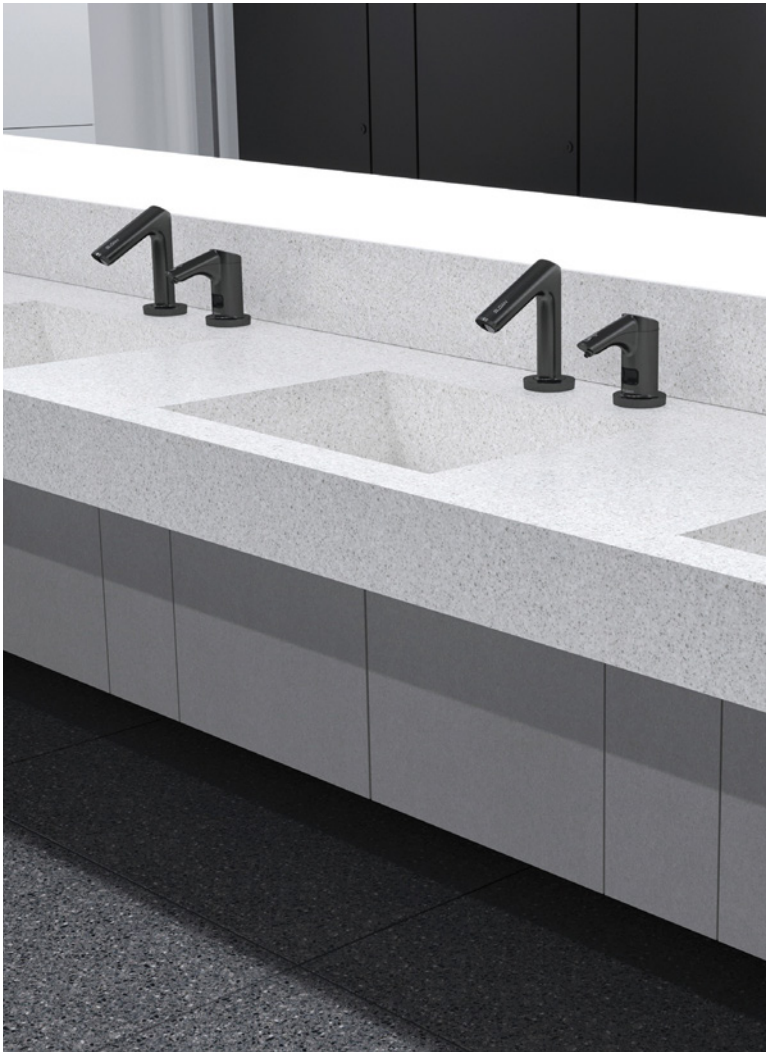

Above- or below-deck

Sloan offers a broad range of faucet options to meet your maintenance needs. Our faucets with above-deck access allow maintenance personnel to replace key components such as batteries and solenoids. You can even shut off the water without having to go under the deck. This helps alleviate labor, cost, and facility down-time should issues arise.

We also offer an extensive line of below-deck faucet and soap dispenser options that help improve your existing facility.

- Above-deck Options: 7 faucet lines
- Below-deck Options: 18 faucet lines

Optima® ETF-420 Faucet and ESD-420 Soap Dispenser in Graphite on Designer Series™ DSG-84000 Gradient Sink in Corian® Silver Birch with cabinet style enclosure in Wilsonart® Shadow Zephyr laminate.

New Top-fill ESD-360 Soap Dispenser and PURELL® REDIFOAM™ Soap

Our new Top-fill ESD-360 Soap Dispenser offers an easily refillable system that is the only closed, top-fill soap dispenser on the market.

FEATURES AND BENEFITS

- Facility managers and maintenance staff will appreciate staying out from underneath the sink to refill the soap dispenser
- Top-fill design reduces labor time and helps eliminate safety concerns
- Our patented refill bottle locks into place, allowing for hands-free refills without the risk of overflow and ensures the entire contents of the refill bottle can be used so no soap is wasted
- All-metal components built to handle the higher traffic commercial settings
- Choose the right power option for your location, including AC adapters, hardwired, or batteries

PURELL® REDIFOAM™ in partnership with Sloan

FEATURES AND BENEFITS

- Foam is created at the point of dispensing, so the system doesn't lose its prime, providing the perfect foam every time even during diminished occupancy
- Our easy fill soap dispenser works in tandem with the 2000mL refill for PURELL® REDIFOAM™ Healthy Soap formula that eliminates the risk of the dispenser clogging
- Never run out of or waste soap with the ability to quickly top off the soap dispenser
- The soap is free of harsh preservatives, antibacterials, parabens, phthalates, fragrances, dyes and the refill bottle is fully recyclable



Optimix® Faucets

Sloan's Optimix-enabled faucets offer the industry's fastest, most effective in-spout ASSE 1070 compliant anti-scald technology—even with a cold water failure.

FEATURES AND BENEFITS

- Meets anti-scald requirements of ASSE 1070
- Maintains water temperature stability if cold water fails
- Integrated Thermostatic Mixing Valve makes installation quick and hassle-free
- Mixer lever can be set to the desired temperature and removed for tamper resistance
- Meets all US (UPC and IPC) plumbing code requirements
- Available in hardwired, battery, and the only solar-powered anti-scald faucet in the industry

Premier

Elegant forms. Enhanced customizations. Our premier faucets, soap dispensers, and hand dryers feel right at home with classic and contemporary restroom designs. Use all three fixtures with the AER-DEC® Integrated Sink System, or pair just the faucet and soap dispenser on our Designer Series™ or SloanStone® Sinks.

New Optima® ETF-410/ ETF-810 and EBF-415/ EBF-815 Faucets and ESD-410 Soap Dispenser

Bring finely crafted geometric forms into your next project with our new touch-free faucets and soap dispensers. The smooth curves and defined angles make this pairing ideal for catching light and turning heads. See them as a complete restroom offering in our Clark Street® Collection. Now available with wall-mounted option.

All premier faucet and soap dispenser variations shown on page 18.



FAUCET FEATURES

- Available with 0.35 gpm/1.3 Lpm or 0.5 gpm/1.9 Lpm flow rates
- Multi-laminar spray type
- Battery or hardwired with battery back-up
- For use with the Optima Control Box
- Manage settings with the Sloan Connect® App

SOAP DISPENSER FEATURES

- Battery or hardwired (with purchase of AC adapter sold separately)
- GOJO refills available at 1500 or 2300ml
- Comes with two bottles of 1500ml soap

Special finishes: In addition to our standard finish, Polished Chrome, our Optima ETF-410/ETF-810 and EBF-415/EBF-815 Faucets, and ESD-410 Soap Dispenser can be ordered with special finishes found on page 5.

AER-DEC® Integration: Available for use with AER-DEC Integrated Sink System in 2023. Contact Sloan for additional information.

Shown: Optima EBF-815 Faucet and ESD-410 Soap Dispenser in Polished Chrome on Designer Series™ DSG-82000 Gradient Sink in Silestone® Poblenu.

Shown opposite: Optima ETF-410 Faucet and ESD-410 Soap Dispenser in Graphite on Designer Series DSOF-84000 Open Front Sink in Corian® Deep Cloud with cabinet style enclosure in Wilsonart® Blackbird laminate.

New Optima® ETF-420/ETF-820 and EBF-425/EBF-825 Faucets and ESD-420 Soap Dispenser

Find inspiration for your next design in the organic, modern aesthetic of our latest touch-free faucet and soap dispenser pairing. See them as a complete restroom offering in our Rush Street® Collection. Express your vision and expand your portfolio through a unified restroom design. Now available with wall-mounted option.

All premier faucet and soap dispenser variations shown on page 18.



Special finishes: In addition to our standard finish, Polished Chrome, our Optima ETF-420/ETF-820 and EBF-425/EBF-825 Faucets, and ESD-420 soap dispenser can be ordered with special finishes found on page 5.

AER-DEC® Integration: Available for use with the AER-DEC Integrated Sink System in 2023. Contact Sloan for additional information.

Shown: Optima EBF-825 Faucet and ESD-420 Soap Dispenser in Graphite on Designer Series™ DSG-82000 Gradient Sink in Silestone® Posidonia Green.

Shown opposite: Optima ETF-420 Faucet and ESD-420 Soap Dispenser in Polished Brass on SloanStone® ELGR-82000 Gradient Sink in SloanStone White with cabinet style enclosure in Wilsonart® Sumner Oak.



Available as part of the Rush Street® Collection.
Learn more at sloan.com/collections

FAUCET FEATURES

- Available with 0.35 gpm/1.3 Lpm or 0.5 gpm/1.9 Lpm flow rates
- Multi-laminar spray type
- Battery or hardwired with battery back-up
- For use with the Optima® Control Box
- Manage settings with the Sloan Connect® App

SOAP DISPENSER FEATURES

- Battery or hardwired (with purchase of AC adapter sold separately)
- GOJO refills available at 1500 or 2300ml
- Comes with two bottles of 1500ml soap

PREMIER



Available as part of the Hubbard Street® Collection.
Learn more at sloan.com/collections

BASYS® EFX Faucets with matching ESD-400/ESD-500 Soap Dispensers

Sleek and modern interchangeable BASYS Faucet components and elegant automatic soap dispensers pair the latest in handwashing technology with clean design. The versatile design can meet the needs of any application or environment—from aesthetics to sensor type and flow rate. The BASYS Hand Dryer perfectly complements the faucet and soap dispenser for a total handwashing solution.

All premier faucet and soap dispenser variations shown on page 18.



Special finishes: In addition to our standard finish, Polished Chrome, our BASYS line including deck-mounted hand dryer can be ordered with special finishes on page 5.

Shown above and opposite: BASYS EFX-250 Faucet, ESD-400 Soap Dispenser, and EHD-510 Deck-mounted Hand Dryer on AER-DEC® AD-82000 Sink in Corian® Blue Pebble with cabinet style enclosure in Wilsonart® Neo Walnut laminate.

FAUCET FEATURES

- Available with 0.5 gpm/1.9 Lpm or 1.5 gpm/5.7 Lpm flow rates
- Aerated, laminar, or multi-laminar spray types
- Battery, hardwired with battery back-up, solar, or turbine powered
- Manage settings with the Sloan Connect® App with optional BT adapter (sold separately)
- All serviceable components above-deck
- Optional LCD display for a guided handwashing experience

SOAP DISPENSER FEATURES

- Hardwired for ESD-400. Battery or hardwired (with purchase of AC adapter sold separately) for ESD-500
- Foam soap dispensers
- Delivers pre-measured foam soap “on demand”
- Ships with 2 – GOJO 1500ml refills (ESD-500 only)



Customize your product with an engraved crown

Sloan’s laser-etched engraved crowns offer the final touch to the complete brand story and make your commercial restroom truly unique. Add corporate logos, team names, venue names, or even design patterns to the faucet crowns—the possibilities are limitless.

Engravings are available on Polished Chrome BASYS EFX Faucets with bowed (plain) crowns.

Cubs logo not available for retail sale unless approved by Major League Baseball.

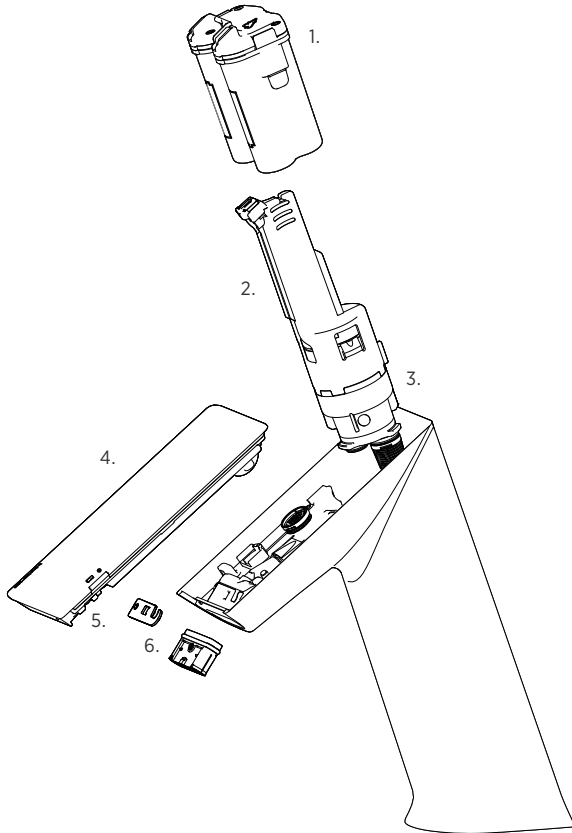

1. Battery caddy

Easily accessible and watertight.

2. Valve caddy/water shut-off

Shuts off water supply with one twist, without having to go below the sink.

3. Solenoid + filter

Bi-stable solenoid with integrated filter.

4. Removable crown

Upgrade product features in seconds.

5. External indicators

Individual external diagnostic LEDs help quickly identify faucet status.

6. Exchange tool + spray insert

Allows operators to remove, clean, and replace the spray.

A world of options

BASYS® is centered on a robust system of shared features and components. This fundamentally different approach revolutionized the commercial plumbing industry by streamlining service and advancing the user experience.

Above-deck controls

Easy, above-deck access to key components is the standard for all BASYS models. The on-board electronics are completely sealed within each faucet’s modular crown, which can be removed with a single Allen wrench.

Interchangeable crowns

Interchangeable crowns help tailor a product to fit the unique needs of a particular installation.



Bowed

A clean, bowed crown is the standard for all models. It provides a smooth, sleek appearance.



Solar

Solar panels embedded in the crown draw power from artificial and natural light sources.



Guided Handwashing

The LCD display instructs users how to perform a CDC-compliant hand wash.

Flow rates and spray types

Three spray types provide options to adjust the flow rate, look, and feel of the water.



Multi-laminar

0.5 gpm



Aerated

1.5 gpm



Laminar

1.5 gpm



BASYS® Guided Handwashing Faucet

The BASYS LCD display guides users through the CDC-compliant handwashing steps to improve hygiene:

1. Wet

Wet your hands with clean, running water

2. Lather

Lather your hands together with soap

3. Scrub

Scrub your hands for at least 20 seconds

4. Rinse

Rinse your hands well under clean, running water

5. Dry

Dry your hands completely

The guided handwashing prompts are gentle suggestions for users to follow and do not limit the usage of the faucet.



Retrofit any BASYS to include timed, guided handwashing.

Interchangeable crowns help tailor a product to fit the unique needs of a particular installation. Crowns are interchangeable with models that utilize the same method of sensing. Any BASYS Faucet can be retrofitted with the timed display crown.

Optima® ETF-410/EBF-415 Faucets and ESD-410 Soap Dispenser



Low-height Faucet

ETF-410 Hardwired
EBF-415 Battery

Available in 5 finishes

✧ *Bluetooth-enabled*



Wall-mounted Faucet

ETF-810 Hardwired
EBF-815 Battery

Available in 5 finishes

✧ *Bluetooth-enabled*



Soap Dispenser

ESD-410 Battery

Available in 5 finishes



ESD-411 Combination

Includes **EBF-415** Faucet and
ESD-410 Soap Dispenser

Available in Polished Chrome

Optima ETF-420/EBF-425 Faucet and ESD-420 Soap Dispenser



Mid-height Faucet

ETF-420 Hardwired
EBF-425 Battery

Available in 5 finishes

✧ *Bluetooth-enabled*



Wall-mounted Faucet

ETF-820 Hardwired
EBF-825 Battery

Available in 5 finishes

✧ *Bluetooth-enabled*



Soap Dispenser

ESD-420 Battery

Available in 5 finishes



ESD-421 Combination

Includes **EBF-425** Faucet and
ESD-420 Soap Dispenser

Available in Polished Chrome



Bluetooth-enabled refers to the technology built directly into the hardware of the faucet.

Bluetooth with adapter refers to the faucet being Bluetooth capable with the addition of the Bluetooth Adapter found on page 7.

BASYS® EFX Faucets with matching ESD-400/ESD-500 Soap Dispenser



Low-height Faucet

- EFX-300** Hardwired
- EFX-350** Battery
- EFX-375** Battery + solar
- EFX-377** Battery + solar + guided handwashing
- EFX-380** Battery + turbine

Available in Polished Chrome

✦ Bluetooth with adapter



Low-height with Integrated Base Faucet

- EFX-600** Hardwired
- EFX-650** Battery
- EFX-675** Battery + solar
- EFX-677** Battery + solar + guided handwashing
- EFX-680** Battery + turbine

Available in Polished Chrome

✦ Bluetooth with adapter



Mid-height Faucet

- EFX-200** Hardwired
- EFX-250** Battery
- EFX-275** Battery + solar
- EFX-277** Battery + solar + guided handwashing
- EFX-280** Battery + turbine

Select items available in 5 finishes

✦ Bluetooth with adapter



High Faucet

- EFX-100** Hardwired
- EFX-150** Battery
- EFX-175** Battery + solar
- EFX-177** Battery + solar + guided handwashing
- EFX-180** Battery + turbine

Available in Polished Chrome

✦ Bluetooth with adapter



Wall-mounted Faucet

- EFX-800** Hardwired
- EFX-850** Battery

Available in Polished Chrome

✦ Bluetooth with adapter



Soap Dispenser

- ESD-400** Hardwired

Available in 5 finishes



Soap Dispenser

- ESD-500** Hardwired

Available in 5 finishes



ESD-501 Combination

- Includes **EFX-250** Faucet and **ESD-500** Soap Dispenser

Available in Polished Chrome

Deluxe

Our deluxe faucets and soap dispensers bring a wide range of design concepts into aesthetic harmony and feature reliable and efficient technology built for any application. Pair these faucets with a soap dispenser and add to any of our Designer Series™ or SloanStone® Sinks.





Optima® EAF-100/EAF-150 Series Faucets and ESD-1500 Soap Dispenser

This faucet and soap dispenser pairing captures the dynamic nature of water using simple forms. Behind the scenes, these precisely-engineered faucets and soap dispensers offer sensor operation that helps you maintain a better facility.

All deluxe faucet and soap dispenser variations shown on page 26.

Shown above: Optima EAF-100 Faucet and ESD-1500 Soap Dispenser on Designer Series™ DSCT-86000 Counter Top Sink in Corian® Blue Pebble with SS-3021 Undermount Lavatory with angled enclosure in stainless steel.

Shown opposite: Optima EBF-85 Faucet with ESD-800 Soap Dispenser on Designer Series DSOF-82000 Open Front Sink in Corian® Designer White.

FAUCET FEATURES

- Available with 0.35 gpm/1.3 Lpm, 0.5 gpm/1.9 Lpm, 1.0 gpm/3.8 Lpm, 1.5 gpm/5.7 Lpm, or 2.2 gpm/8.3 Lpm flow rates
- Aerated, laminar, or multi-laminar spray types
- Battery or hardwired
- Hardwired units can use optional BT adapter for Sloan Connect® access
- EAF44 power splitter included with select models

SOAP DISPENSER FEATURES

- Battery or hardwired (with purchase of AC adapter sold separately)
- Compatible with 1500 or 2300ml refill sizes
- Ships with 2 soap refills



Featured in the State Street® Collection.
Learn more at sloan.com/collections

Optima® EAF-200/EAF-250/ EAF-275/EAF-225 Series Faucets and ESD-2000 Soap Dispenser

Sturdy and cylindrical, our faucets and soap dispensers combine sleek curves with a defined profile. This pairing can bring a welcome touch of elegance to mass-market concepts or fit comfortably into the most exclusive facilities.

All deluxe faucet and soap dispenser variations shown on page 26.

Shown above: Optima EAF-250-ISM Faucet and ESD-2000 Soap Dispenser in Graphite on Designer Series™ DSWD-82000 Weir Deck Sink in Corian® Glacier White with cabinet style enclosure in Wilsonart® Black laminate.

Shown opposite: Optima EAF-350 in Graphite on SloanStone® ELA-81000 Arrowhead Sink in SloanStone White.

FAUCET FEATURES

- Available with 0.35 gpm/1.3 Lpm, 0.5 gpm/1.9 Lpm, 1.0 gpm/3.8 Lpm, 1.5 gpm/5.7 Lpm, or 2.2 gpm/8.3 Lpm flow rates
- Aerated, laminar, or multi-laminar spray types
- Battery, hardwired, or solar powered
- Hardwired units can use optional BT adapter for Sloan Connect® access

SOAP DISPENSER FEATURES

- Battery or hardwired (with purchase of AC adapter sold separately)
- Compatible with 1500 or 2300ml refill sizes
- Ships with 2 soap refills

Optima® EAF-300/EAF-350 Series Faucets

Timeless faucet design meets wireless technology with our Optima EAF-300/EAF-350 Series Faucets. This hardware is the perfect fit for any facility. Best of all, this series takes high-tech touches anywhere with long-lasting battery-powered components.

All deluxe faucet and soap dispenser variations shown on page 26.

FAUCET FEATURES

- Available with 0.35 gpm/1.3 Lpm, 0.5 gpm/1.9 Lpm, 1.5 gpm/5.7 Lpm, or 2.2 gpm/8.3 Lpm flow rates
- Aerated or multi-laminar spray types
- Battery or hardwired
- Hardwired units can use optional BT adapter for Sloan Connect® access





Featured in the Halsted Street® Collection.
Learn more at sloan.com/collections

Optima® ETF-80/EBF-85 Faucets and ESD-800 Soap Dispenser

Durable construction. Smooth, curvaceous design. Our Optima ETF-80/EBF-85 Faucets and ESD-800 Soap Dispensers give you the freedom to define flow rate while complementing design concepts from classic to contemporary.

All deluxe faucet and soap dispenser variations shown on page 26.

Shown above: Optima EBF-85 Faucet and ESD-800 Soap Dispenser in Polished Chrome on Designer Series™ DSG-86000 Gradient Sink in Corian® Glacier White with cabinet style enclosure in Wilsonart® Neo Walnut laminate.

Shown opposite: Optima EAF-700 Faucet and ESD-700 Soap Dispenser in Polished Chrome on SS-3306 Wall-mounted Ledgeback Lavatory.

FAUCET FEATURES

- Available with 0.35 gpm/1.3 Lpm, 0.5 gpm/1.9 Lpm, 1.0 gpm/3.8 Lpm, 1.5 gpm/5.7 Lpm, or 2.2 gpm/8.3 Lpm flow rates
- Aerated, laminar, or multi-laminar spray types
- Battery or hardwired with battery back-up
- For use with the Optima Control Box
- Manage settings with the Sloan Connect® App

SOAP DISPENSER FEATURES

- Battery or hardwired (with purchase of AC adapter sold separately)
- Compatible with 1500 or 2300ml refill sizes
- Ships with 2 soap refills

Optima® EAF-700/EAF-750 Series Faucets and ESD-700 Soap Dispenser

Complete your restroom's aesthetic with classic faucet forms paired with our reliable IR sensor technology.

Optima EAF-700/EAF-750 Series Faucets and ESD-700 Soap Dispensers feature timeless gooseneck curves and sturdy cylindrical bases.

All deluxe faucet and soap dispenser variations shown on page 26.

FAUCET FEATURES

- Available with 0.35 gpm/1.3 Lpm, 0.5 gpm/1.9 Lpm, 1.5 gpm/5.7 Lpm, or 2.2 gpm/8.3 Lpm flow rates
- Aerated, laminar, or multi-laminar spray types
- Battery or hardwired
- Hardwired units can use optional BT adapter for Sloan Connect® access (sold separately)

SOAP DISPENSER FEATURES

- Battery or hardwired (with purchase of AC adapter sold separately)
- Compatible with 1500 or 2300ml refill sizes
- Ships with 2 soap refills



Optima® EAF/ETF/EBF Faucets and Matching ESD Soap Dispensers



Mid-height Faucet
EAF-200 Hardwired
EAF-250 Battery
EAF-275 Battery + solar
Select items available in 5 finishes
Optimix®-enabled anti-scald
 ✦ Bluetooth with adapter



Executive Mid-height Faucet
EAF-225 Hardwired
With illuminated temperature indicator
Available in Polished Chrome



Soap Dispenser
ESD-2000 Battery
Available in 5 finishes



ESD-2001 Combination
 Includes **EAF-275-ISM** Faucet and **ESD-2000** Soap Dispenser
Available in Polished Chrome



Mid-height Faucet
EAF-100 Hardwired
EAF-150 Battery
Available in Polished Chrome
 ✦ Bluetooth with adapter



Soap Dispenser
ESD-1500 Battery
Available in Polished Chrome



ESD-1501 Combination
 Includes **EAF-150-ISM** Faucet and **ESD-1500** Soap Dispenser
Available in Polished Chrome



Mid-height Faucet
EAF-300 Hardwired
EAF-350 Battery
Select variations available in Graphite



Top-fill Soap Dispenser
ESD-360 Hardwired with plug or battery
Available in Polished Chrome



Mid-height Faucet
ETF-880 Hardwired
EBF-187 Battery or battery + turbine
Available in Polished Chrome
 ✦ Bluetooth-enabled



Wall-mount Faucet
ETF-800 Hardwired
EBF-850 Battery or battery + turbine
Available in Polished Chrome
 ✦ Bluetooth-enabled



Mid-height Faucet
ETF-80 Hardwired
EBF-85 Battery or battery + turbine
Available in Polished Chrome

✧ Bluetooth-enabled



Soap Dispenser
ESD-800 Battery
Available in Polished Chrome



ESD-801 Combination
Includes **EBF-85** Faucet and **ESD-800** Soap Dispenser
Available in Polished Chrome



Bluetooth-enabled refers to the technology built directly into the hardware of the faucet.

Bluetooth with adapter refers to the faucet being Bluetooth capable with the addition of the Bluetooth Adapter found on page 7.



Executive Gooseneck Faucet
EAF-700 Hardwired
EAF-750 Battery
Available in Polished Chrome

✧ Bluetooth with adapter



Soap Dispenser
ESD-700 Battery
Available in Polished Chrome



ESD-701 Combination
Includes **EAF-750-ISM** Faucet and **ESD-700** Soap Dispenser
Available in Polished Chrome



Gooseneck Wall-mount Faucet
ETF-500 Hardwired
EBF-550 Battery or battery + turbine
Available in Polished Chrome
✧ Bluetooth-enabled



High Gooseneck Faucet
ETF-700 Hardwired
EBF-750 Battery or battery + turbine
Available in Polished Chrome
✧ Bluetooth-enabled



Surgical Bend Faucet
ETF-700-H Hardwired
EBF-750-H Battery or battery + turbine
Available in Polished Chrome
✧ Bluetooth-enabled

STANDARD

Standard

Our standard faucets include sensor operation and precise engineering at a budget-friendly price.

Featured in the Lake Steet® Collection.
Learn more at sloan.com/collections



Sloan® SF Faucets

Bring the convenience of touch-free sensor activation to any project with Sloan SF Series Faucets and ESD-2100 Soap Dispensers. These touch-free products offer reliable IR sensors, efficient water savings, and great value.

All standard faucet and soap dispenser variations shown on page 30.

FAUCET FEATURES

- Available with 0.35 gpm/1.3 Lpm, 0.5 gpm/1.9 Lpm, 1.0 gpm/3.8 Lpm, 1.5 gpm/5.7 Lpm, or 2.2 gpm/8.3 Lpm flow rates
- Aerated, laminar, or multi-laminar spray types
- Battery or hardwired

Shown above: Sloan SF-2300 Faucet on SS-3065 Wall-mounted Ledgeback Lavatory with SS-27 Shroud.

Shown opposite: Sloan SF-2150 Faucet and ESD-2100 Soap Dispenser in Polished Chrome on SloanStone® ELRF-83000 Round Front Sink in SloanStone White with custom cabinet style enclosure in Wilsonart® Natural Rift laminate.

Sloan® SF Faucets



Mid-height Faucet

SF-2900 Hardwired
SF-2950 Battery

Available in Polished Chrome



Wall-mount Faucet

SF-2800 Hardwired
SF-2850 Battery

Available in Polished Chrome



Low-height Faucet

SF-2100 Hardwired
SF-2150 Battery

Available in Polished Chrome



Soap Dispenser

ESD-2100 Battery

Available in Polished Chrome



ESD-2101 Combination

Includes **SF-2150** Faucet and
ESD-2100 Soap Dispenser

Available in Polished Chrome



Mid-height Faucet with integrated base

SF-2300 Hardwired
SF-2350 Battery

Available in Polished Chrome



Mid-height Faucet

SF-2400 Hardwired
SF-2450 Battery

Available in Polished Chrome



Gooseneck Faucet

SF-2200 Hardwired
SF-2250 Battery

Available in Polished Chrome



Shown: Sloan® SF-2900 Faucet on Designer Series™ DSG-81000 Gradient Sink in Silestone® Ethereal Noctis.

LEGACY

Legacy

Our original line of sensor-operated faucets.

Shown: Optima® ETF-660 Faucet in Polished Chrome
on SS-3003 Wall-mounted Lavatory.

Optima® ETF/EBF Faucets

Ideal for applications that require a reliable sensor-activated faucet and efficient water savings. These products are field-tested, hard-working, and vandal-resistant to keep facilities in working order — as they have with decades of service.

FAUCET FEATURES

- Available with 0.35 gpm/1.3 Lpm, 0.5 gpm/1.9 Lpm, 1.0 gpm/3.8 Lpm, 1.5 gpm/5.7 Lpm, or 2.2 gpm/8.3 Lpm flow rates
- Aerated, laminar, or multi-laminar spray types based on model selected
- Battery or hardwired with battery back-up
- For use with the Optima® Control Box
- Manage settings with the Sloan Connect® App



Low-height Faucet

ETF-610 Hardwired
EBF-615 Battery or battery + turbine

Available in Polished Chrome

✧ *Bluetooth-enabled*



Soap Dispensers

ESD-600 Battery

Available in Polished Chrome



ESD-601 Combination

Includes **ETF-610** Faucet and **ESD-600** Soap Dispenser

Available in Polished Chrome



Low-height Faucet with integrated base

ETF-600 Hardwired
EBF-650 Battery or battery + turbine

Available in Polished Chrome

✧ *Bluetooth-enabled*



Low-height Faucet with side sensor

ETF-660 hardwired, with side sensor

Available in Polished Chrome

✧ *Bluetooth-enabled*



Gooseneck Faucet with side sensor

ETF-770 Hardwired
EBF-775 Battery or battery + turbine

Available in Polished Chrome

✧ *Bluetooth-enabled*

THE SLOAN FULL LINE FAUCET COLLECTION CHART

		FEATURES										OPTIONS							
		Spout Type					Sensor Type	Service Access		Functions		Matching Products		Power					
Line	Product Series	Low	Mid	High	Integrated Base	Gooseneck	Wall	Infrared	Capacitance/Proximity	Above Deck	Below Deck	Auto Water Shut-off	Line Flush	Matching Soap Dispenser	Matching Hand Dryer	Hardwired	Battery	Battery with Solar	Battery with Turbine
Premier	EFX-100, EFX-150, EFX-175, EFX-177, EFX-180			•				•		•		•	•	•	•	•	•	•	•
	EFX-200, EFX-250, EFX-275, EFX-277, EFX-280		•					•		•		•	•	•	•	•	•	•	•
	EFX-375, EFX-377	•						•	•	•		•	•	•	•		•	•	•
	EFX-300, EFX-350, EFX-380	•						•	•		•	•	•	•	•	•	•	•	•
	EFX-675, EFX-677				•			•	•	•		•	•	•	•		•	•	•
	EFX-600, EFX-650, EFX-680				•			•	•		•	•	•	•	•	•	•	•	•
	EFX-800, EFX-850, EFX-875, EFX-877						•	•				•	•	•	•	•	•	•	•
	ETF-410, ETF-810, EBF-415, EBF-815	•					•	•				•	•	•	•	•	•	•	•
	ETF-420, ETF-820, EBF-425, EBF-825		•				•	•				•	•	•	•	•	•	•	•
Deluxe	EAF-100, EAF-150		•					•		•		•	•		•	•			
	EAF-200, EAF-250, EAF-275		•					•		•		•	•		•	•	•		
	EAF-225		•					•		•		•	•		•				
	EAF-300, EAF-350		•					•		•		•	•		•	•			
	EAF-700, EAF-750					•		•		•		•	•		•	•			
	ETF-80, EBF-85, ETF-880, ETF-187		•					•			•	•	•	•		•	•		•
	ETF-500, EBF-550					•	•	•			•	•	•			•	•		•
	ETF-700, EBF-750, EBF-755, ETF-700-H, EBF-750-H					•		•			•	•	•			•	•		•
ETF-800, EBF-850						•	•			•	•	•			•	•		•	
Standard	SF-2100, SF-2150		•					•			•			•		•	•		
	SF-2200, SF-2250					•		•			•					•	•		
	SF-2300, SF-2350		•		•			•			•					•	•		
	SF-2400, SF-2450			•				•			•					•	•		
	SF-2800, SF-2850						•	•			•					•	•		
	SF-2900, SF-2950		•					•			•					•	•		
Legacy	ETF-610, EBF-615	•						•			•	•	•	•		•	•		•
	ETF-600, EBF-650	•			•			•			•	•	•	•		•	•		•
	ETF-660	•						•			•	•	•			•	•		•
	ETF-770, EBF-775					•		•			•	•	•			•	•		•

*May require purchase of separate spray head **Some not available in all flow rates ***Optional adapter sold separately



Front cover: Optima® ETF-410 Faucet and ESD-410 Soap Dispenser in Graphite on Designer Series™ DSOF-84000 Open Front Sink in Corian® Deep Cloud with cabinet style enclosure in Wilsonart® Blackbird laminate.

Back cover: Optima ETF-420 Faucet and ESD-420 Soap Dispenser in Polished Brass on SloanStone® ELGR-82000 Gradient Sink in SloanStone White with custom cabinet style enclosure in Wilsonart Summer Oak laminate.

SLOAN®

Water Connects Us®

World Headquarters

10500 Seymour Avenue
Franklin Park, IL 60131
U.S.A.

800.982.5839
sloan.com

Follow Sloan

[f /sloanvalvecompany](https://www.facebook.com/sloanvalvecompany)

[@sloan](https://twitter.com/sloan)

[@sloan](https://www.instagram.com/sloan)

[/sloan_valve](https://www.pinterest.com/sloan_valve)

[in /sloan-valve-company](https://www.linkedin.com/company/sloan-valve-company)